

AVERAGING TEMPERATURE SENSOR

Available in 6', 12' and 24' Lengths

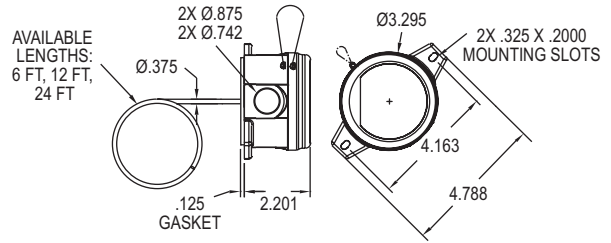

The **Series TE-A Averaging Temperature Sensor** features a long bendable aluminum capillary to measure the average temperature in large ducts and air handler units.

FEATURES/BENEFITS

- Easy to mount external tab housing
- 1/4 turn housing cover with chain
- Multiple conduit knockouts for easy installation positioning

APPLICATIONS

- Building automations
- Air handler unit monitoring
- Large air duct temperature monitoring

SPECIFICATIONS

Accuracy: Thermistor temperature sensor: $\pm 0.22^{\circ}\text{C}$ @ 25°C ($\pm 0.4^{\circ}\text{F}$ @ 77°F).
Temperature Limits: -40 to 302°F (-40 to 150°C).
Capillary Lengths: 6, 12 or 24' (depending on model).
Cable Length: 4'.
Sensor Curves: See page reference 1 below.
Probe Material: Bendable aluminum probe.
Housing Material: Meets UL, 94 V-0 polycarbonate plastic.
Weight: 14 oz (397 g).

MODEL CHART

Model	Sensor Type	Capillary Length	Model	Sensor Type	Capillary Length
TE-AAG-A0634-00	10k type III NTC thermistor	6'	TE-AAG-C0634-00	3k NTC thermistor	6'
TE-AAG-A1234-00	10k type III NTC thermistor	12'	TE-AAG-C1234-00	3k NTC thermistor	12'
TE-AAG-A2434-00	10k type III NTC thermistor	24'	TE-AAG-C2434-00	3k NTC thermistor	24'
TE-AAG-B0634-00	10k type II NTC thermistor	6'	TE-AAG-F0634-00	20k NTC thermistor	6'
TE-AAG-B1234-00	10k type II NTC thermistor	12'	TE-AAG-F1234-00	20k NTC thermistor	12'
TE-AAG-B2434-00	10k type II NTC thermistor	24'	TE-AAG-F2434-00	20k NTC thermistor	24'

1 Resistance vs. Temperature Table: See page 162 (Series TE-OND/RND/OSA)

SERIES CC1

AVERAGING TEMPERATURE SENSOR CLIPS

3/8", 1/4", or 1/8" Sensor Diameters

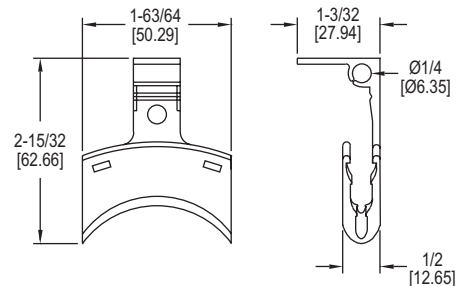

The **Series CC1 Averaging Temperature Sensor Clips** are used to mount the capillary of an averaging temperature sensor to the wall of the duct or air handler. Slots are provided for using nylon zip ties to hold the tubing in place, if needed.

FEATURES/BENEFITS

- Works with Series TE-A sensors
- Gray or natural color options
- 3/8", 1/4", or 1/8" sensor diameters

APPLICATIONS

- Building automation
- Averaging temperature sensor mounting

MODEL CHART	
Model	Color
CC1-N	Natural
CC1-GY	Grey
Note: Sold individually	